

WebEx/Schoology Log in Directions for Students

1. Open the Galileo Homepage: Galileo.d11.org
2. Open the WebEx Link in a second tab. Look for the WebEx Icon on the home page



3. Sign into WebEx then open a third tab for Schoology
4. Select the course you need to join.
5. Students: look for this link for your teacher.



Chapman Q2 Advisory P1

If you are logging into a device for the first time you will need to authenticate your account.

1. This is what your teacher's meeting room might look like.

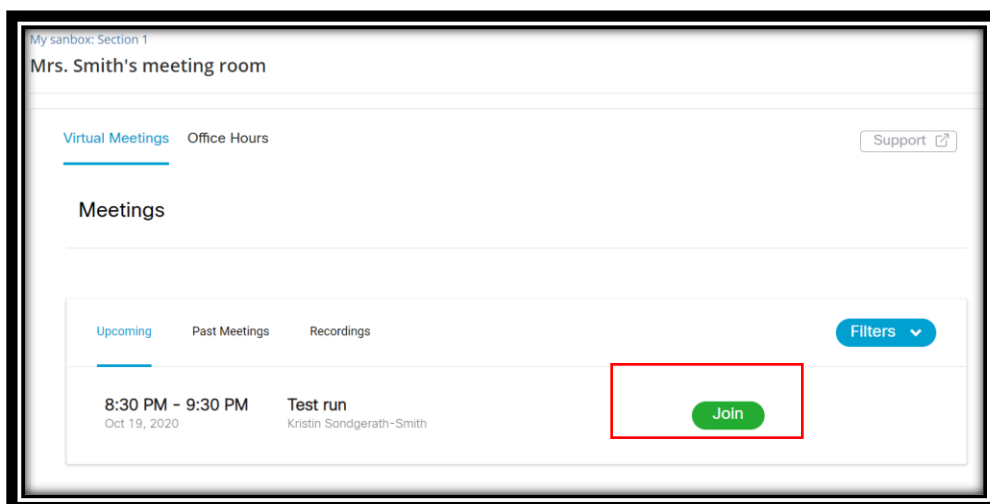

2. Click Join

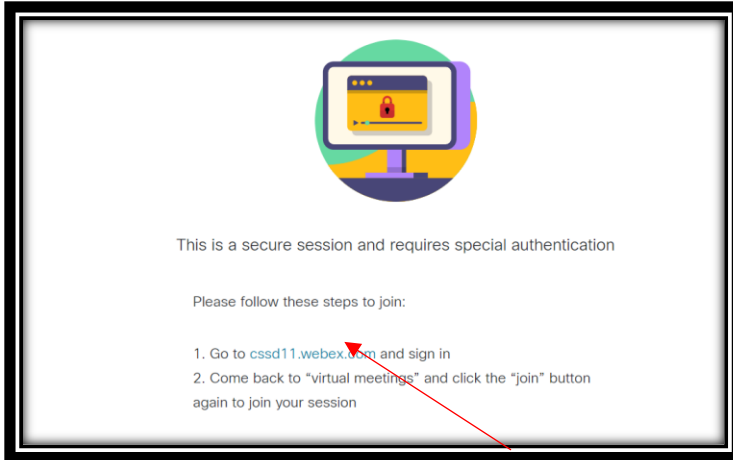

3. It is possible that the next page will look like this. If so, click on the cssd11.webex.com link and sign in using your district e-mail and password. Look for the blue sign in button on the top right corner of your screen.

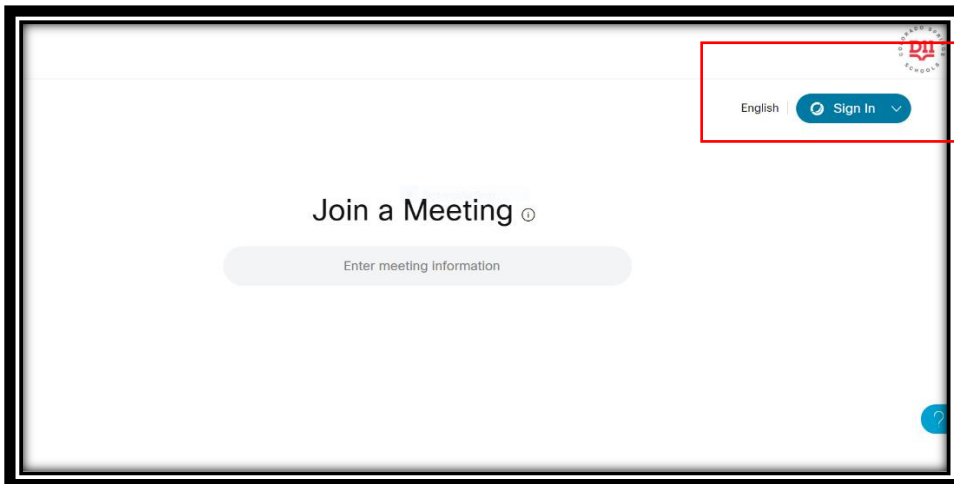

- 4. Click Sign in under the D11 logo**
- 5. Enter your d11 e-mail, then next**

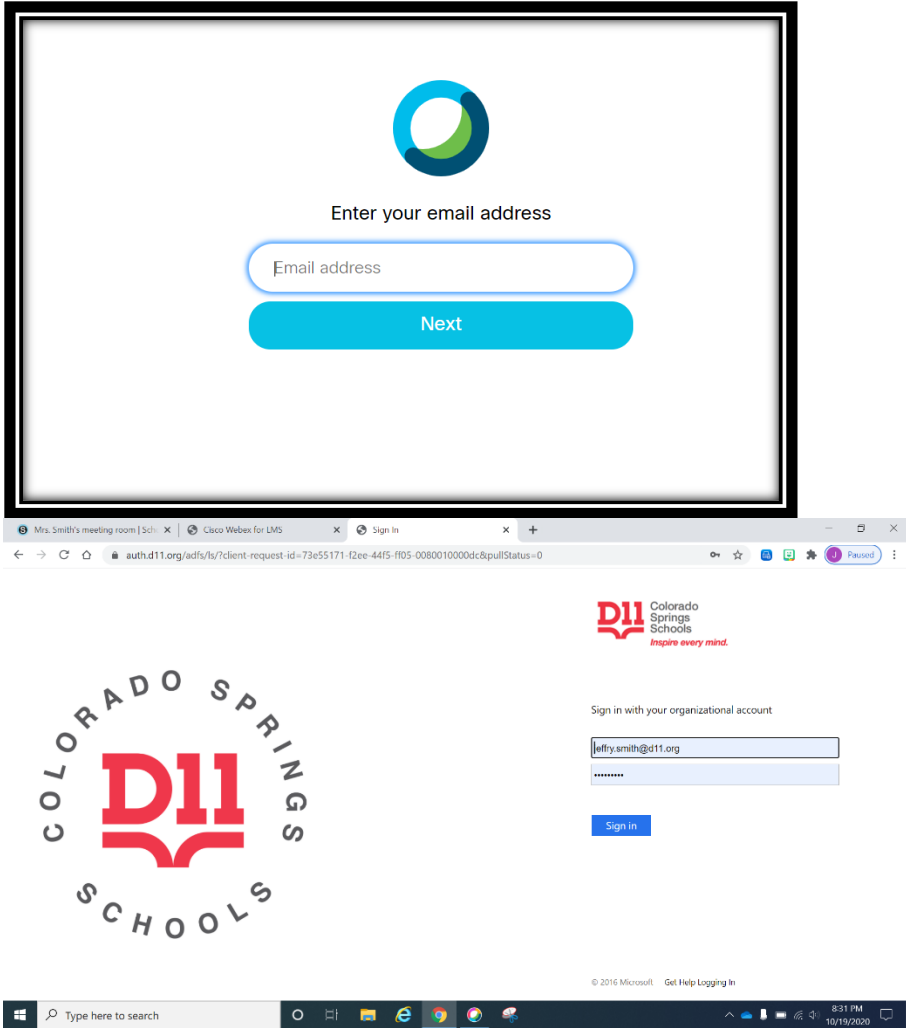

6. Make sure the information is correct when the d11 page comes up. If you need to reenter your e-mail and password. Then click sign in.

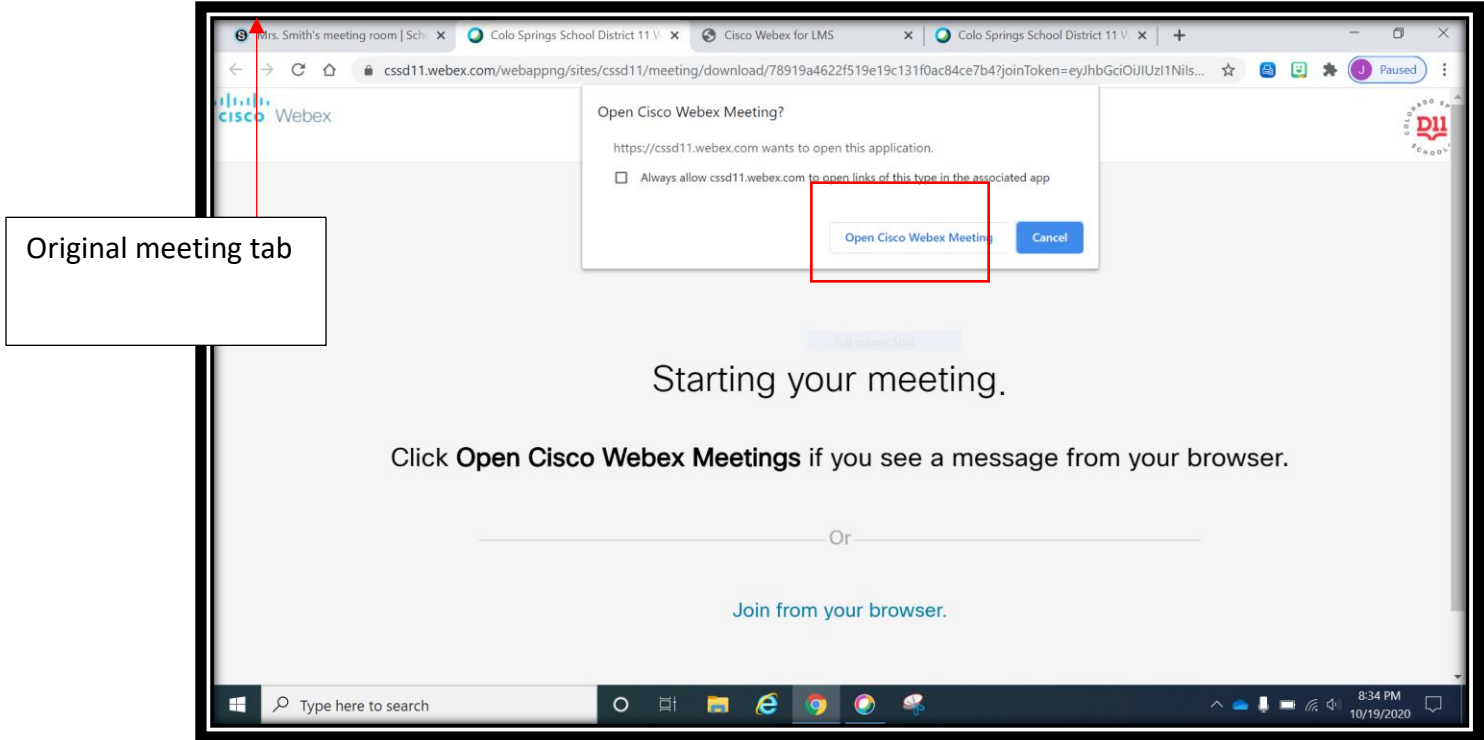

Original meeting tab

7. Click open Cisco WebEx meeting. If this does not work, go back to the original tab with the meeting and click join